



# UNTERMINATED ETHERNET 10BASE-2 (BNC) MODULE INSTALLATION GUIDE

For the LANplex 2500/2016

## Module Description

This module contains eight (8) unterminated Ethernet 10BASE-2 ports that use BNC connectors. If a port on this module is at the end of a 10BASE-2 (BNC) segment, you must provide an external 50 Ohm terminator.



*When the port is at the end of a segment, using a T connector with a terminating plug may cause interference with adjacent ports. 3Com recommends terminating ports with the ITT Pomona Y connector, Model 4896, with a terminating plug on the end, or the ITT Pomona Feed-Thru Terminator, Model 4119-50. When the port is in the middle of a segment, the Y connector may be necessary.*



*Prior to installing the unterminated 10BASE-2 (BNC) module, LANplex system software revision 7.0.0 or later and LANplex diagnostics software revision 3.0.2 or later must be installed. A system software revision supporting this module is available from the 3com BBS, the Internet FTP site (3Com.ftp.com), or 3Com Forum on CompuServe, or 3Com's Web site ([http://infodeli.3com.com/infodeli/swlib/switch\\_files.htm](http://infodeli.3com.com/infodeli/swlib/switch_files.htm)).*

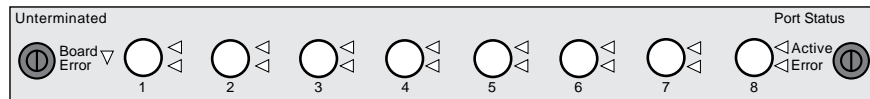

For a description of how to configure this module into your network, see the LANplex documentation set.

*Audience This guide is intended for trained technical personnel only.*

**Status LEDs** The option module contains one **Board Error** LED, eight port status **Active** LEDs, and eight port status **Error** LEDs. Depending on the condition, the port status LED is either **Active** (green) or **Error** (yellow). See the table below for a description of the status LEDs.

LED	Name	Color	Description
Module Status	Board Error	Yellow	Indicates that either an error has occurred or the option module has failed a diagnostic procedure
Port Status	Active	Green	Indicates that the associated port is active
	Error	Yellow	Indicates that an error condition has occurred with the associated port or that the port was disabled from the Administration Console

**Safety Information** Electrostatic discharge (ESD) can damage components on the module. ESD occurs when the module is improperly handled and can cause complete or intermittent failures.

To prevent ESD-related damage:

- Always wear the ESD wrist strap provided with the LANplex system, ensuring that it makes good skin contact
- Keep the module in its antistatic shielded bag until you are ready to install it
- Do not touch the components, pins, leads, or solder connections
- Always handle the module by its edges

**Prior to Installation** Before you install your new module, follow the appropriate pre-installation instructions in this section.

*Read if initial installation*

Your LANplex system is shipped with protective faceplates covering the exposed installation slots. You must remove the protective faceplate covering the selected installation slot prior to installing the option module.



**CAUTION:** *When handling modules, 3Com recommends that you always use a wrist strap connected to a proper ground. This helps prevent the module from being damaged by electrostatic discharge. Additionally, when not in use, the module should be stored in an antistatic bag.*

To remove the faceplate:

- 1 Loosen the two captive screws securing the faceplate to the chassis.
- 2 Pull the faceplate away from the system.

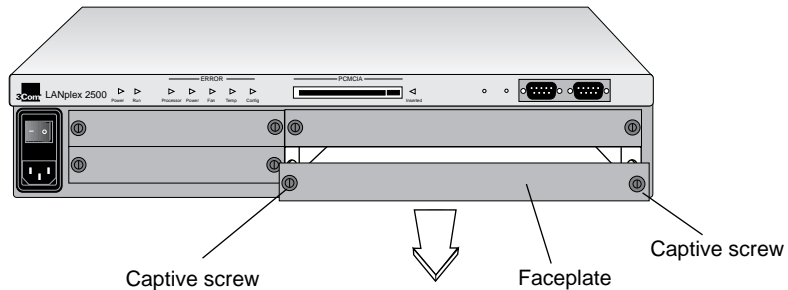

*Read if replacing  
a module*

You can replace a module while the system is powered on. Replacing the module requires that you remove the attached cables from the module's ports prior to installing the new module.

To replace a module:

- 1 Disconnect the cables from the module's ports.
- 2 Loosen the two captive screws securing the module to the chassis.
- 3 Pull the module out of the chassis.

The following figures show termination of unterminated BNC ports using either a Y connector or a Feed-thru terminator.

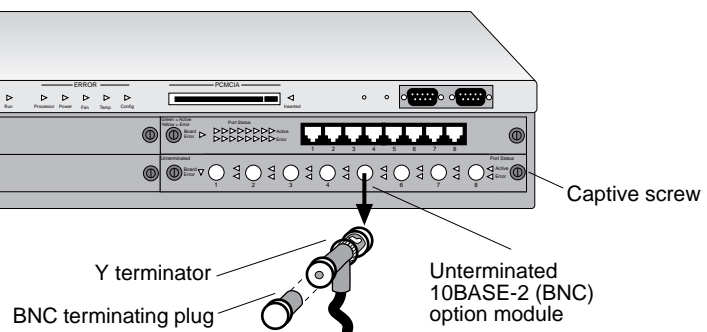

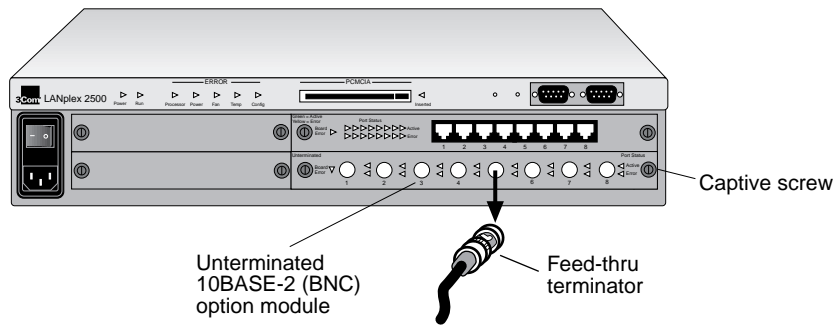

**i** The LANplex system will automatically reset when a module has been installed with the power on.

**i** If you physically change the configuration of the system after defining an IP interface, the port designated for that interface may no longer be valid. You may have to redefine the interface. For information on defining an IP interface, see the Administration Console User Guide for your LANplex system.

### Installing the Module

To install the new module into the LANplex system, perform the following steps:

- 1 Ensure that you are properly grounded.
- 2 Remove the module from its antistatic bag.

**⚡ WARNING** If the system is powered on when you are replacing the module, do not insert any metal objects, such as a screwdriver or a finger wearing jewelry, in the open slot. This could cause burns or other bodily harm.

- 3 Place the module between the guides of the selected slot and slide the module into the chassis. See the figure below.

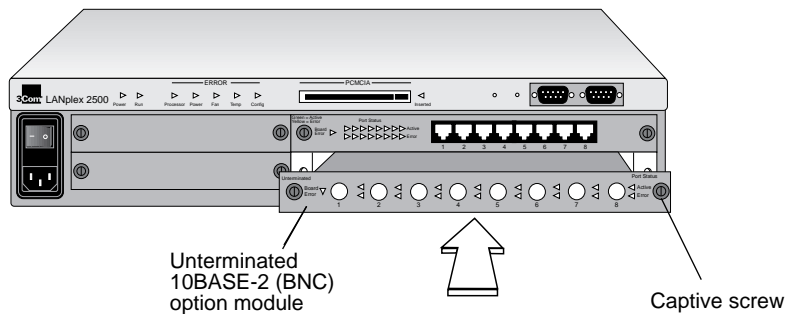

- 4 To seat the module, firmly push the module forward to engage the module and backplane connectors. You will feel a slight resistance as the connectors engage.



**CAUTION:** *If the resistance is too great, the module and backplane connectors may not be aligned. Forcing the module forward could damage the board or backplane connectors. If necessary, remove and reinsert the module, ensuring that the connectors are properly aligned. You should not have to seat the module by tightening the captive screws.*

- 5 Tighten the captive screws to secure the module in the chassis.

Once the module is installed, see Chapter 4: *Cabling the System* in your *Getting Started* guide for information on cabling the module to the network.

### Option Module Diagnostics

Module diagnostics run at power up or when replacing a module with the power on. During diagnostics, the module's port status **Error** LEDs are lit yellow. When diagnostics are successfully completed, the port status **Active** LEDs turn green for those ports that are cabled. If any port status **Error** LEDs remain yellow, the port is not operational. If the module's **Board Error** LED is lit yellow, the module has failed a diagnostic test. To troubleshoot module failures see Chapter 7: *Troubleshooting the System* in your *Getting Started* guide.

---

3Com Corporation  
5400 Bayfront Plaza  
Santa Clara, California  
95052-8145

© 3Com Corporation, 1996. All rights reserved. No part of this documentation may be reproduced in any form or by any means or used to make any derivative work (such as translation, transformation, or adaptation) without permission from 3Com Corporation.

3Com Corporation reserves the right to revise this documentation and to make changes in content from time to time without obligation on the part of 3Com Corporation to provide notification of such revision or change.

3Com Corporation provides this documentation without warranty of any kind, either implied or expressed, including, but not limited to, the implied warranties of merchantability and fitness for a particular purpose. 3Com may make improvements or changes in the product(s) and/or the program(s) described in this documentation at any time.

3Com and LANplex are registered trademarks of 3Com Corporation. 3Com registered trademarks are registered in the United States, and may or may not be registered in other countries. Other brand and product names may be registered trademarks or trademarks of their respective holders.

Part No. 801-00321-000  
Published May 1996  
Revision 01